



# Pacific Grove Adult Education Child Care Center

subtitle

---

---



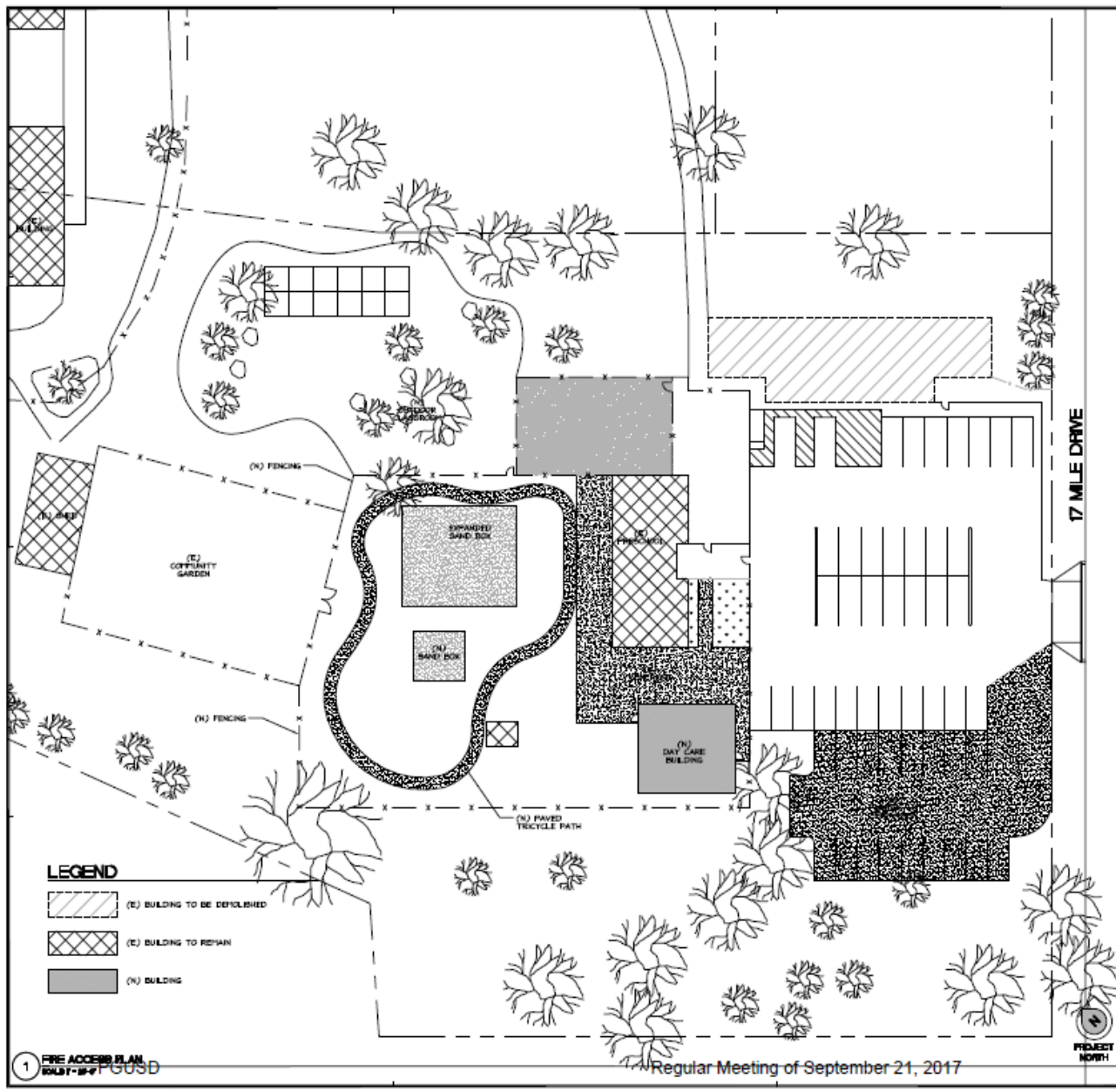

**GENERAL NOTES**

- (E) FIRE TRUCK ACCESS LANE IN THIS PLAN SHALL COMPLY WITH THE FOLLOWING REQUIREMENTS, TYP. TOUR, MEETING THE 10'-6" MIN. HEIGHT CLEARANCE REQUIREMENT.
- (E) FIRE TRUCK ACCESS LANE IS CAPABLE OF SUPPORTING THE IMPOSED LOAD OF FIRE APPARATUS NEARING AT LEAST 47,000 LBS.
- (E) FIRE TRUCK ACCESS SHALL HAVE AN UNOBSTRUCTED WIDTH OF NOT LESS THAN 20 FEET.
- (E) GATED SHALL COMPLY WITH CFC 503.5.6 AND CFC 503.5.7.  
(E) KNOCK-PADLOCK SHALL COMPLY WITH CFC 503.5.6 AND CFC 503.5.7.
- FIRE HYDRANT(S) SHALL BE WITHIN 400'-0" OF THE PROPOSED BUILDINGS PER CFC 507.8.1.
- ALL EXTERIOR WALLS OF THE PROPOSED BUILDINGS SHALL BE WITHIN 50'-0" OF THE APPROVED FIRE ACCESS ROAD, PER CFC 503.1.1.
- NEW RELOCATABLE CLASSROOMS WILL BE EQUIPPED WITH NDA FIRE/EMERGENCY VOICE EVACUATION SYSTEM.

**LEGEND**

---	PROPERTY LINE	[Solid Grey]	(E) BUILDINGS
- - - -	(E) FENCE	[Diagonal Hatching]	(N) BUILDINGS TO BE DEMOLISHED
→	ACCESSIBLE EGRESS PATH OF TRAVEL FOR NEW CONSTRUCTION	[Cross-hatching]	(E) BUILDINGS TO BE RETAINED
(A)	M.D.S. LEGEND DENIGATION	[Dotted]	(E) LANDSCAPE/LAWN
(B)	(E) FIRE HYDRANT (F.H.)	[Stippled]	(E) A/C PAVED AREA - TYP.
[Hatched]	LINE DENOTES FIRE TRUCK ACCESS LANE (PROVIDE 2" WIDE GRAY BURLAP BRIMS DASHED LINE PARKING)		

**LEGEND**

[Diagonal Hatching]	(E) BUILDING TO BE DEMOLISHED
[Cross-hatching]	(E) BUILDING TO BE RETAINED
[Solid Grey]	(N) BUILDING

1 FIRE ACCESS PLAN  
 08/17/17  
 CUSD

Regular Meeting of September 21, 2017



REVISIONS

NO.	DATE	DESCRIPTION

SEAL

REGISTERED PROFESSIONAL ARCHITECT  
 STATE OF CALIFORNIA  
 NO. 10000  
 JAMES W. HARRIS

HELLMUTH OBATA KASSABAUM ARCHITECTS  
 1000 MARIN AVENUE, SUITE 200  
 SAN FRANCISCO, CALIFORNIA 94102  
 TEL: 415.774.8000  
 WWW.HOK.COM

**BOI**  
 PROFESSIONAL DESIGN

FIRE ACCESS PLAN  
 (N) DAY CARE CENTER FOR  
**PACIFIC GROVE UNIFIED SCHOOL DISTRICT**  
 1005 LUMBERLAKE AVE  
 PACIFIC GROVE, CA

DATE: AS NOTED  
 DRAWN: C.E.  
 CHECKED: TRPB  
 SHEET: **A1.1**

THIS PLAN IS THE PROPERTY OF THE ARCHITECT. IT IS TO BE USED ONLY FOR THE PROJECT AND SITE SPECIFICALLY IDENTIFIED HEREON. ANY REUSE OR MODIFICATION OF THIS PLAN WITHOUT THE WRITTEN CONSENT OF THE ARCHITECT IS PROHIBITED. THE ARCHITECT ASSUMES NO LIABILITY FOR DAMAGES OF ANY KIND, INCLUDING CONSEQUENTIAL DAMAGES, ARISING FROM THE USE OF THIS PLAN OR THE INFORMATION CONTAINED HEREIN.

# PACIFIC GROVE ADULT SCHOOL CHILD CARE PROJECT

Preliminary Budget September 13, 2017

<u>Description</u>	<u>Quantity</u>	<u>Unit</u>	<u>Total</u>
<u>Hard Costs</u>			
1. Site Work (Grading, Utilities, Concrete, Pad Preparation, Paving, Electrical, Low Voltage)	22,000 sf	\$18.50	\$407,000.00
2. 40x60 (2,400 SF) Relocatable Classroom	1 Ea	\$395,000.00	\$395,000.00
3. Playground - (Structure, Fall Material, Flatwork, Drainage)	1 Is	\$50,000.00	\$50,000.00
4. Outdoor Classroom	1 Is	\$10,000.00	\$10,000.00
5. Landscaping	1 Is	\$15,000.00	\$15,000.00
	0		
	Sub Total		\$877,000.00
<u>Soft Costs</u>			
1. Design & Topo Fees	1 LS	\$85,000.00	\$85,000.00
2. DSA Fees	1 %	\$877,000.00	\$8,770.00
3. Testing & Inspection	2 %	\$877,000.00	\$17,540.00
	Sub Total		\$111,310.00
	<b>Hard + Soft Costs Subtotal</b>		<b>\$988,310.00</b>
Contingency	5%		\$49,415.50
	<b>Total</b>		<b>\$1,037,725.50</b>